

FUMEX®

TERFU



A local extractor with friction joints for worksites where great flexibility is required.

TERFU is a local extractor with friction joints designed for use in workplaces where great flexibility is required e.g. laboratories and production environments in lighter industrial applications.

Simple, easy function

The friction joints have a large frictional diameter and are supported with ball bearings. The degree of friction is easily adjusted with a one-hand knob. Adapted support springs balance out the weight of the arm. All arms are equipped with a 360 degree rotational swivel mounted in place. An air tight damper is fitted as standard.

Always easy to select the right product

Terfu is available in two versions:

- Standard version. Suitable for evacuation of most types of airborne contaminants.
- PP version. Most suitable for evacuation of highly corrosive contaminants in high concentrations.

All sizes are suitable for table mounting, ceiling mounting and wall mounting.

The same suction arm is used for suspended mounting from ceilings and walls.

Ceiling and wallbrackets consists of anodised square section aluminium profile for high finish and good stability.

All ceiling brackets are available in eight standard lengths up to 2 m. Longer lengths can be supplied to special orders.

To further simplify your mounting and provide a neat finish, escutcheon plate MTI CT can be used if it is necessary to cut holes in the false ceiling.

The TERFU system is design protected with several patents- and design protections pending.

The Fumex range also includes fans, accessories, automatic control and filters suitable for local extraction.

LOCAL EXTRACTION
Pure advantages

FUMEX® TERFU

TERFU Models



Standard version of Terfu with polypropylene joints and anodised aluminium tubes.

The standard version of Terfu is suitable for evacuation of most types of airborne contaminants from e.g. laboratories, schools, hospitals, pharmaceutical industry, hair dressers and light industrial applications.



Polypropylene (PP) version of Terfu with joints and tubes in recyclable PP. All metal parts that come in contact with the airstream are made from acid resistant stainless steel (SS 2343).

The PP version of Terfu is primarily used for evacuation of extremely corrosive contaminants in high concentrations for certain laboratories, and also pharmaceutical and chemical industries.

When using a ceiling mounted PP extractor, we recommend using an MTI ceiling bracket with internal and external powder coating.

TERFU Maximum flexibility



Terfu joint. The large frictional diameter together with the single grip adjusting knob provide a rigid, stable joint with a smooth easily adjustable function without requiring the application of excessive force or tools. The joint has reinforced side pieces. Ball bearings that isolate the adjusted friction level allow the arm to move up and down without locking the joint or losing stability and function.

Appealing stable brackets

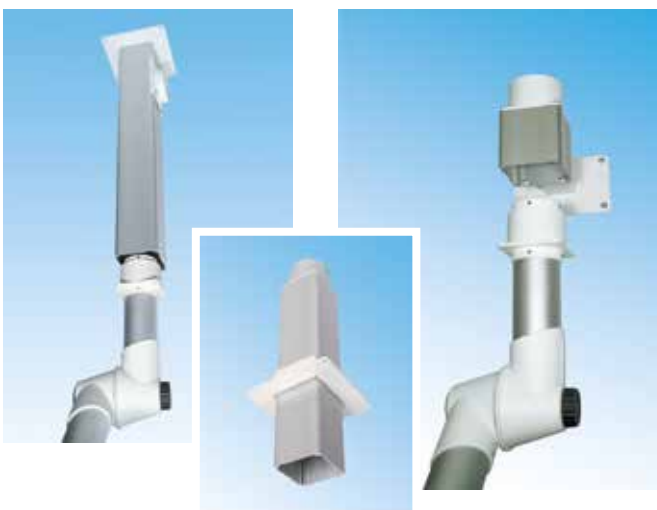

All Terfu extractors have a standard full-swivel that allows 360° of rotation without the need for special sleeves or double wall mountings. Both ceiling and wall brackets consist of a special anodised aluminium profile that provide an appealing, functional installation. The ceiling bracket also acts as the extraction channel, thus avoiding the need for expensive external channeling and additional holes in the finished ceiling.

Installation is simple and stable, the ceiling mount is available in eight standard lengths, from 0.25 to 2.0 m. Lengths greater than 2 m can be supplied to order. The ceiling mount can be provided with internal epoxy coating for use in aggressive environments.

| Ceiling mount | | Size (mm) | | | Weight |
|---------------|----|-----------|-----|----|--------|
| Designation | | A | B | C | kg |
| MT 1000-75 | PP | 400 | 300 | 75 | 2,25 |
| MT 1300-75 | PP | 550 | 450 | 75 | 2,60 |
| MT 1500-75 | PP | 750 | 450 | 75 | 2,75 |
| MT 2000-75 | - | 1000 | 650 | 75 | 3,25 |
| MTS 1500-75 | PP | 750 | 450 | 75 | 3,25 |
| MTS 2000-75 | PP | 1000 | 650 | 75 | 3,75 |

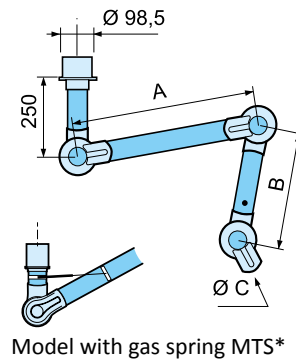

| Wall mount | | Size (mm) | | | Weight |
|-------------|----|-----------|-----|----|--------|
| Designation | | A | B | C | kg |
| MV 1000-75 | PP | 400 | 300 | 75 | 4,40 |
| MV 1300-75 | PP | 550 | 450 | 75 | 4,75 |
| MV 1500-75 | PP | 750 | 450 | 75 | 4,90 |
| MV 2000-75 | - | 1000 | 650 | 75 | 5,40 |
| MVS 1500-75 | PP | 750 | 450 | 75 | 5,25 |
| MVS 2000-75 | PP | 1000 | 650 | 75 | 5,90 |

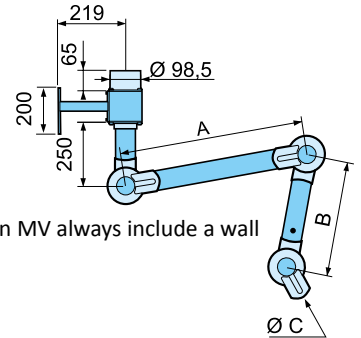

| Table mount | | Size (mm) | | | Weight |
|-------------|----|-----------|-----|----|--------|
| Designation | | A | B | C | kg |
| MT 1000-75 | PP | 400 | 300 | 75 | 2,25 |
| MT 1300-75 | PP | 550 | 450 | 75 | 2,60 |
| MT 1500-75 | PP | 750 | 450 | 75 | 2,75 |

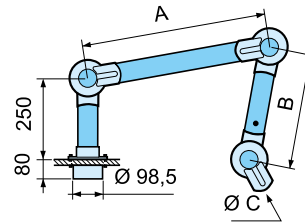

Pressure drop diagram

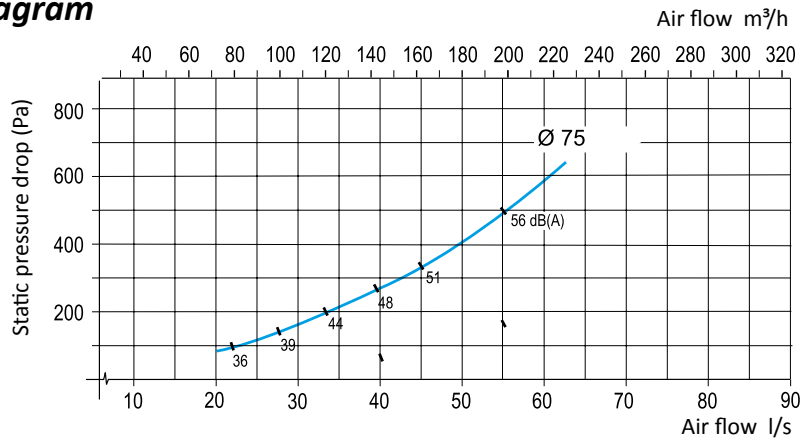

The static pressure drop is measured in accordance with ISO-standard 5167-1. The noise level is measured in accordance with ISO-standard 3741.

Project planning advice

Typical values Terfu

| Function | Air flow | |
|------------|----------|----------|
| Laboratory | 40 l/s | 150 m³/h |
| Schools | 40 l/s | 150 m³/h |

Recommended mounting height

| Designation | H mm |
|-------------|-----------|
| MT 1000 | 1700-2000 |
| MT 1300 | 1900-2200 |
| MT 1500 | 2000-2300 |
| MT 2000 | 2200-2500 |

Recommended side displacement in relation to workplace

| Designation | S mm |
|-------------|----------|
| MT 1000 | 300-600 |
| MT 1300 | 400-700 |
| MT 1500 | 500-800 |
| MT 2000 | 700-1000 |

Range at recommended mounting height

The following mounting heights and side displacements are recommended for optimization of evacuation

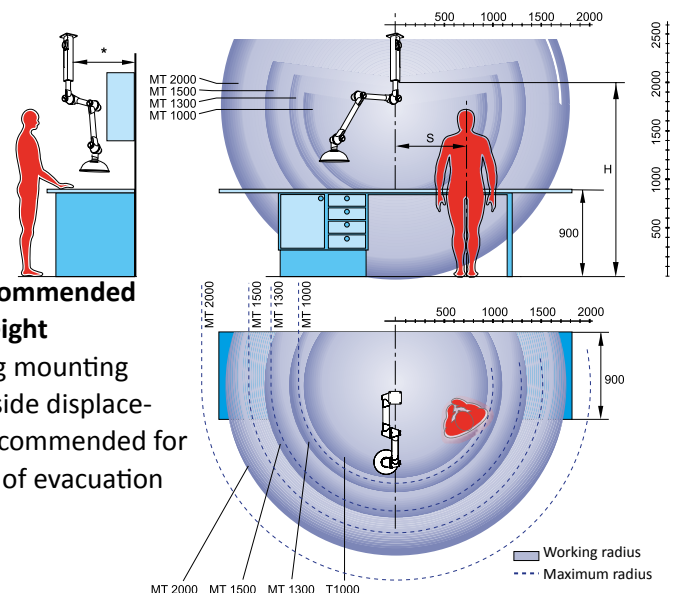

The MTI and MTF ceiling bracket

The ceiling bracket functions as a simple and stable duct for outgoing air, avoiding the need for expensive ducting and additional holes through false ceilings. On request, the MTI can be supplied in lengths exceeding 2 m.

| | Dimensions | Weight |
|----------|------------|--------|
| Standard | L (mm) | (kg) |
| MTI 250 | 250 | 3,15 |
| MTI 500 | 500 | 3,80 |
| MTI 750 | 750 | 4,50 |
| MTI 1000 | 1000 | 5,15 |
| MTI 1250 | 1250 | 5,80 |
| MTI 1500 | 1500 | 6,45 |
| MTI 1750 | 1750 | 7,10 |
| MTI 2000 | 2000 | 7,75 |

Static pressure drop (Pa)

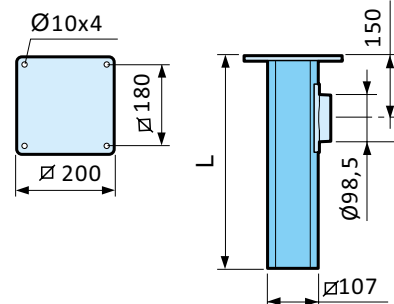
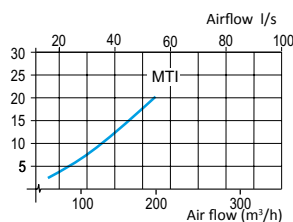

Ceiling bracket, for fitting through beams. The attachment plate is adjustable for the entire length of the aluminium profile. If required, the aluminium profile can be cut during fitting.

| | Dimensions | Weight |
|----------|------------|--------|
| Standard | L (mm) | (kg) |
| MTF | 1000 | 4,20 |

The ceiling brackets can be supplied with an epoxy-coated exterior in all lengths up to 3 m (L).

For aggressive environments, we recommend epoxy coating on the interior and exterior up to 1.25 m (IL).

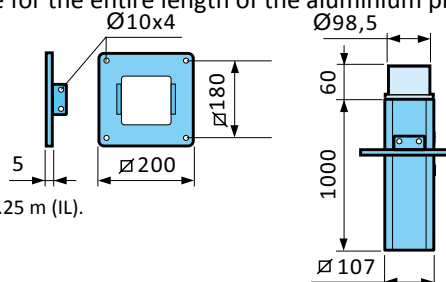

The MTI CT escutcheon plate

Escutcheon plate, used with the MTI ceiling bracket for stabilization and to cover ducting in false ceilings.

| | Weight |
|----------|--------|
| Standard | (kg) |
| MTI CT | 0,050 |

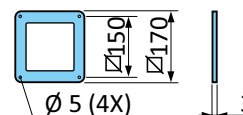

MVK wall bracket

Included as standard for a wall-mounted arm.

Wall brackets can be special ordered in custom horizontal and vertical lengths.

| | Weight |
|----------|--------|
| Standard | (kg) |
| MVK | 2,15 |

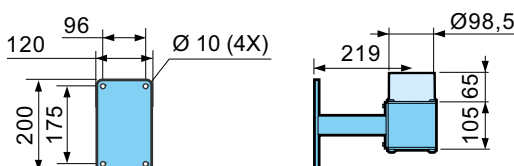

MBF flexible table bracket

Flexible bracket for attaching to a table-top or shelving. Supplied complete with two clamps.

| | Weight |
|----------|--------|
| Standard | (kg) |
| MBF | 0,75 |

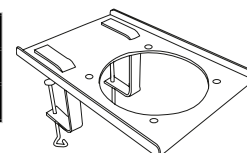

Hoods

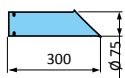

SUCTION NOZZLE

MES 300-75 (PP)

Material

Standard, Aluminium
PP, Polypropylene

Weight, 160 gram

Temp. range -15°C till +80°C

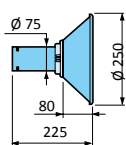

METAL HOOD

MM 250-75

MMB 250-75 equipped with light.

Material

Standard, Aluminium

Weight, 300 gram

Temp. range -15°C till +80°C

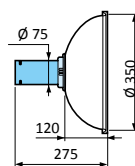

DOME HOOD

MK 350-75 (PP)

Material

Standard, PETG
PP, Polypropylene

Weight, 450 gram

Temp. range -15°C till +80°C

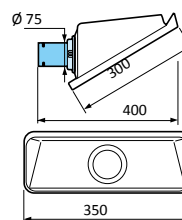

SQUARE HOOD

MSH 350-75

Material

Standard, PETG

Weight, 485 gram

Temp. range -15°C till +80°C

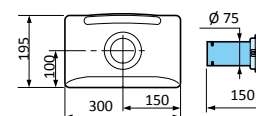

FLAT SCREEN HOOD

MPH 300-75 (PP)

Material

Standard, PETG
PP, Polypropylene

Weight, 365 gram

Temp. range -15°C till +80°C

Material description

Friction joint

Ball-bearing supported adjustable friction joints in polypropylene (PP) with guide ring of low-friction treated rubber.

Support springs and other attachment details in zinc plated steel or stainless steel.

Tube

Made from thin-wall anodised aluminium, alternatively from polypropylene.

Air-tight damper supplied as standard.

Fan and filter

Connects to a separate fan, central extractor system or filter.

Recommended operating temperature -15°C to +80°C.

Delivery

Ceiling- supplied assembled excluding hood or nozzle. Ceiling bracket MTI, or MTF, ordered separately.

Wall- assembled, complete with wall bracket MVK, excluding hood or nozzle.

Table- assembled, with mounting plate for table mounting, excluding hood or nozzle. Flexible table bracket MBF ordered separately.